

Any questions? Call us on +353 (0)1 247 9007

Magnetic Activation

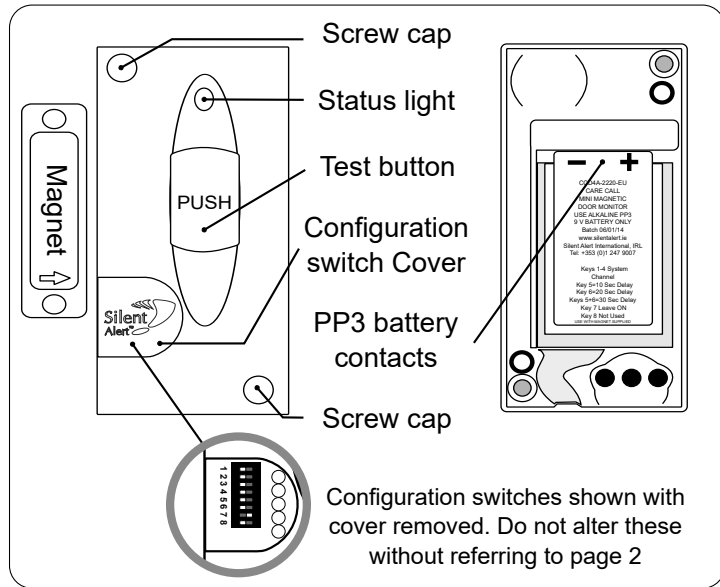

1. Install a 9 volt PP3 alkaline or lithium battery making sure to observe the correct polarity.

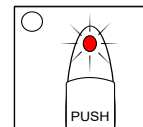
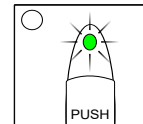
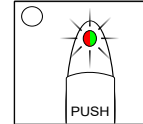
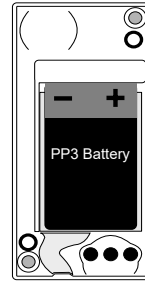

When a battery is first fitted the indicator light will flash red then green a few times then light solid green & pause briefly.

The light will then flash green several times to show the battery voltage.

9 flashes = 9Volts in the battery.

If the light flashes red at this point the battery is flat and will need to be replaced.

To repeat the battery check remove the battery, press the test button then re-insert the battery to start the sequence again.

2. The monitor is activated using an internal reed switch and a magnet.

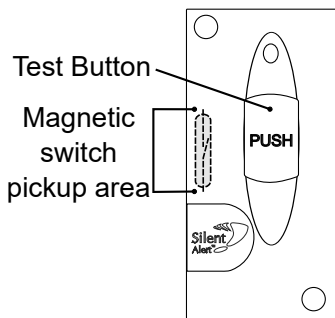

To test the unit press the button on the front of the unit.

Alternatively the supplied magnet can be used to trigger the unit by swiping it through the pickup area.

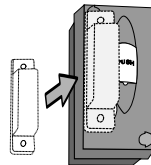

NOTE* The magnet must pass within 1cm of the pickup area to activate the unit.

- 3.

Secure the Mini Monitor to the door frame as close as possible to the edge of the door using the supplied screws.

The Magnet must pass within 1cm of the pickup area to trigger the unit.

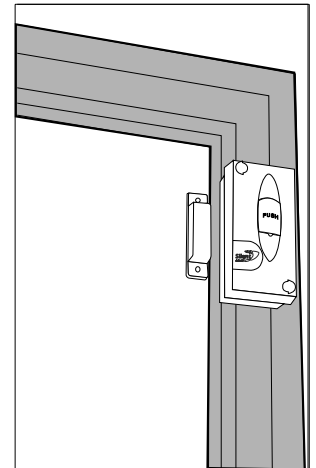
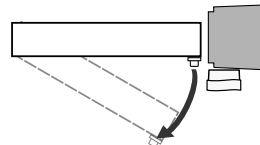

- 4.

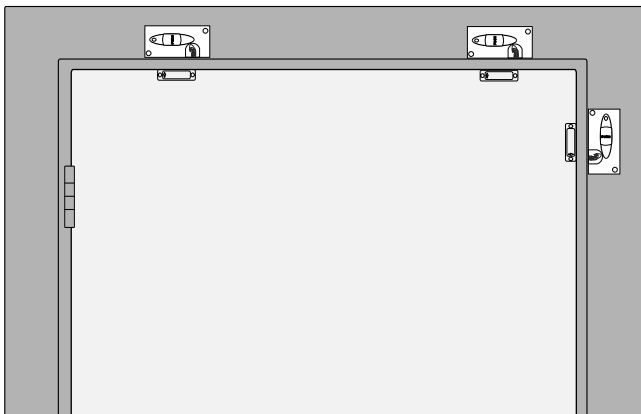

We recommend mounting the monitor opposite to the door hinge. The magnet does not need to be in close proximity to the pickup area when the door is closed as the unit is triggered when the magnet passes through the pickup area.

The magnet needs to pass within 1cm of the pickup area as the door is opened. It is possible to mount the monitor in a variety of positions as shown in the diagram. Experiment to find the best position before fixing to the door frame. Once the optimum position has been established the magnet should be secured to the door frame using the sticky pad or screws provided.

Deactivating & reactivating the door monitor

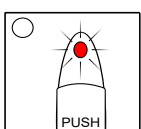

Press and hold the test button until the light flashes red, then release. This will deactivate the door sensor.

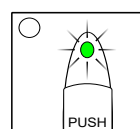

Press and hold the test button until the light flashes green, then release. This will reactivate the door sensor.

Advanced settings CCD4A-2220-EU

Care Call Mini Magnetic Door Monitor



Any questions? Call us on +353 (0)1 247 9007

Changing the Zone

The unit will by default cause zone 1 on the pager or signwave to light.

1.

To change the zone you need to reset the monitor:

Remove the battery, press the push button, replace the battery.

2.

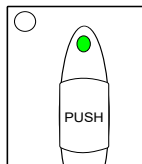

After the flashing red/green startup sequence the light will shine constant green.

3.

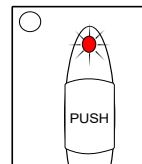

Press and release the button whilst the light is green. The light will flash red once, twice then three times and so on up to twelve.

4.

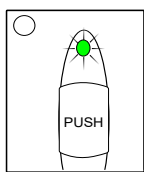

To set the zone number, briefly press the test button at the desired number of flashes.

The indicator light will flash green to confirm the selection.

5.

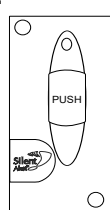

The monitor will then perform the battery voltage level display and start as normal. Press the test button to confirm the correct zone has been selected.

Setting trigger delays

It is possible to set trigger delays allowing a set amount of time to pass for the user to clear the door before the monitor will transmit.

1.

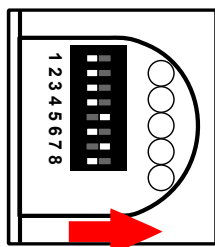

Remove the control key cover by with a small flat bladed screwdriver.

Key 7 will already be set. This must **NOT** be switched off.

To activate the trigger delay move key 5 to the on position.

2.

Now when the door is opened the monitor will flash red for 10 seconds.

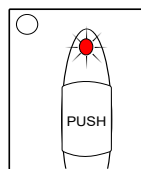

If the door doesn't shut within this time the monitor will transmit.

3.

The delay can be increased if required.

10 seconds

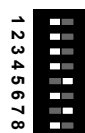

20 seconds



30 seconds

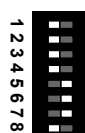

Changing the system channel code

NOTE. In most cases it is not necessary to change the system code. However, when one or more systems are in close proximity, system codes can be used to avoid interference from other Care Call systems using up to a maximum of 16 channels.

The monitor is supplied with no system code switches set (system code 1).

For reference this is the factory setting should you need to re-set the unit.

System codes can be set using key switches 1 - 4.

The diagram to the right shows the 16 possible combinations.

Be sure that the same system code is set on the receiver to be used and any other monitoring options in that system.

